

SECTION 34

SECTION 32

SECTION 36

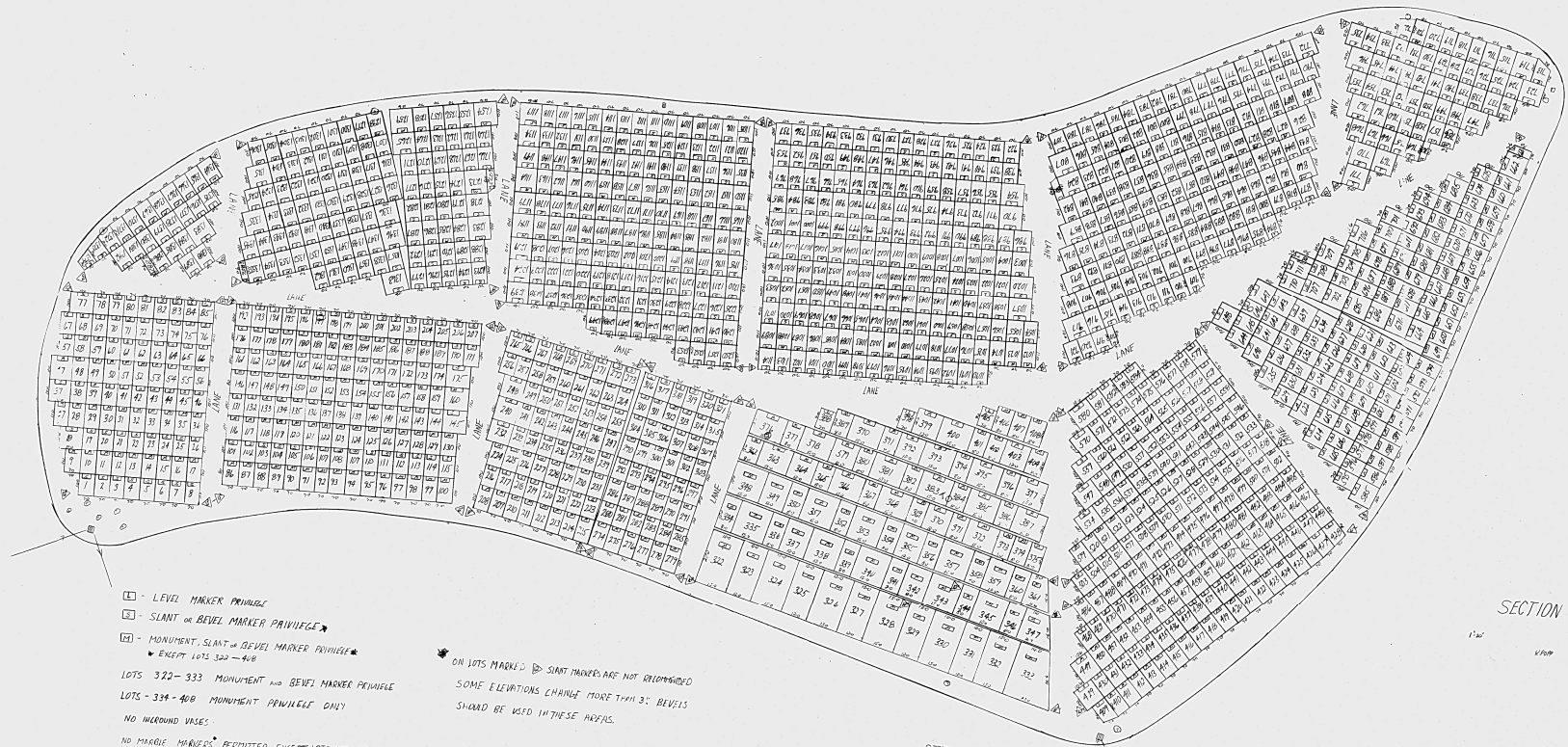

- ☐ - LEVEL MARKER PRIVILEGE
 - ▤ - SLANT OR BEVEL MARKER PRIVILEGE
 - ▣ - MONUMENT, SLANT & BEVEL MARKER PRIVILEGE
 - EXCEPT LOTS 322-406
- LOTS 322-333 MONUMENT AND BEVEL MARKER PRIVILEGE
 LOTS 334-406 MONUMENT PRIVILEGE ONLY
 NO HORIZONTAL VISES
 NO MARKER MARKERS PERMITTED EXCEPT LOTS 322-323
- ▤ 8" MINIMUM BASE & BEVEL MARKER - LOTS 385-1001
 - ▤ 10" MINIMUM BASE & BEVEL MARKER - LOTS 274-305, 571-586
 - ▤ 12" MINIMUM BASE & BEVEL MARKER - LOTS 1-273, 329-333, 341-347, 410-502

ON LOTS MARKED WITH SLANT MARKERS ARE NOT RECOMMENDED
 SOME ELEVATIONS CHANGE MORE THAN 3" BEVELS
 SHOULD BE USED IN THESE AREAS

SECTION 35

112
 VADP
 8771